

452022-580-A4

Rue



#52022-580-B#

L'EVEQUE

110⁰
111^V
111^Y
43 Ca , 44 Dm
15 Ca , 67 Dm

Rue du

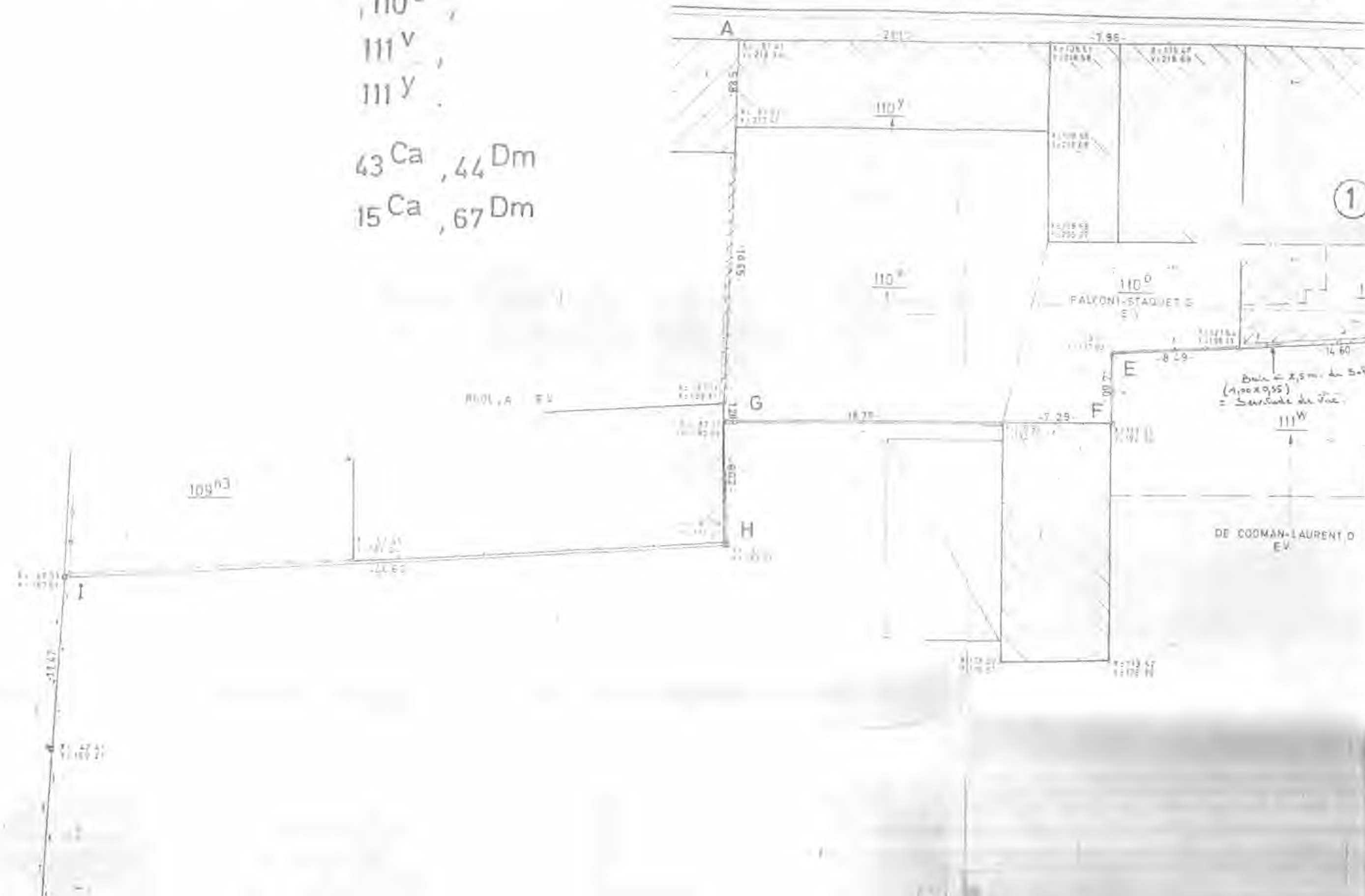

452022-580-C #

2

f3



PLAN DE SITUATION
Echelle 1/10 000

#52022-580-D #

2

96^a → 96^b

96^a

1:50
1:100

109¹³

DE COOMAN-LAURENT, D
E.V.

As 40 35
71.124 35

FOURMEAUX-WEEK,
Vve M. et Enfants
Lernés

100¹²
100¹¹
100¹⁰
100⁹
100⁸
100⁷
100⁶
100⁵
100⁴
100³
100²
100¹

105^s
DE MEESTER, G.
VAN ROMPU-DE MEESTER, S
E.V.

105^t
QUENON, L
E.V.

103ⁿ
HERLOT-DE WEIRO, R
E.V.

98^e

1:100

97^a

15

* 52022-580-E *

98^e

97^a

103ⁿ
PIEPLLOT-DE WEIROD, R
E.V.

100^{e2}
LONGO-LAZZARI, N
E.V.

100^{c2}
IGNA-CRISTADORO, G
E.V.

99^{h3}
DEFONTAINE-DEL COURT
Vve R et Enfants
E.V.

99^{l3}

99^{k3}

SCIPIONI, B
E.V.

COMMUNE	FONTAINE I
S ^o N ^o	Det C
NOTAIRE	CHARPENTIER
DATE ACTE	10.12.85
GÉOMÈTRE	
607219	1113 - CR 47

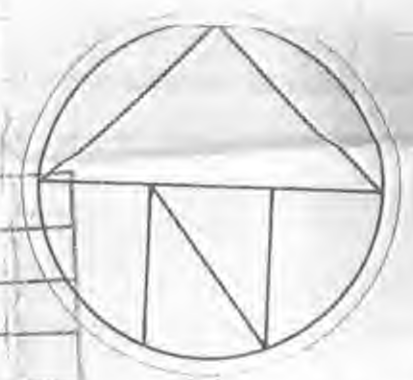

■ BURNE EXISTANTE
○ SOURCE AXE HAIE

-105.01-

V 100

V 50

0.61

X: 46 16
Y: 36 33

X: 49 76
Y: 43 67

X: 76 66
Y: 76 12

X: 83 65
Y: 86 75

X: 87 29
Y: 89 77

X: 91 80
Y: 97 25

X: 95 35
Y: 99 75

X: 97 70
Y: 107 28

20.42

12.73

11.16

4.73

9.92

9.29

3.10

V 100

V 50

0.61

X: 46 16
Y: 36 33

X: 49 76
Y: 43 67

X: 76 66
Y: 76 12

X: 83 65
Y: 86 75

X: 87 29
Y: 89 77

X: 91 80
Y: 97 25

X: 95 35
Y: 99 75

X: 97 70
Y: 107 28

20.42

12.73

11.16

4.73

9.92

9.29

3.10

#52022-580-F #

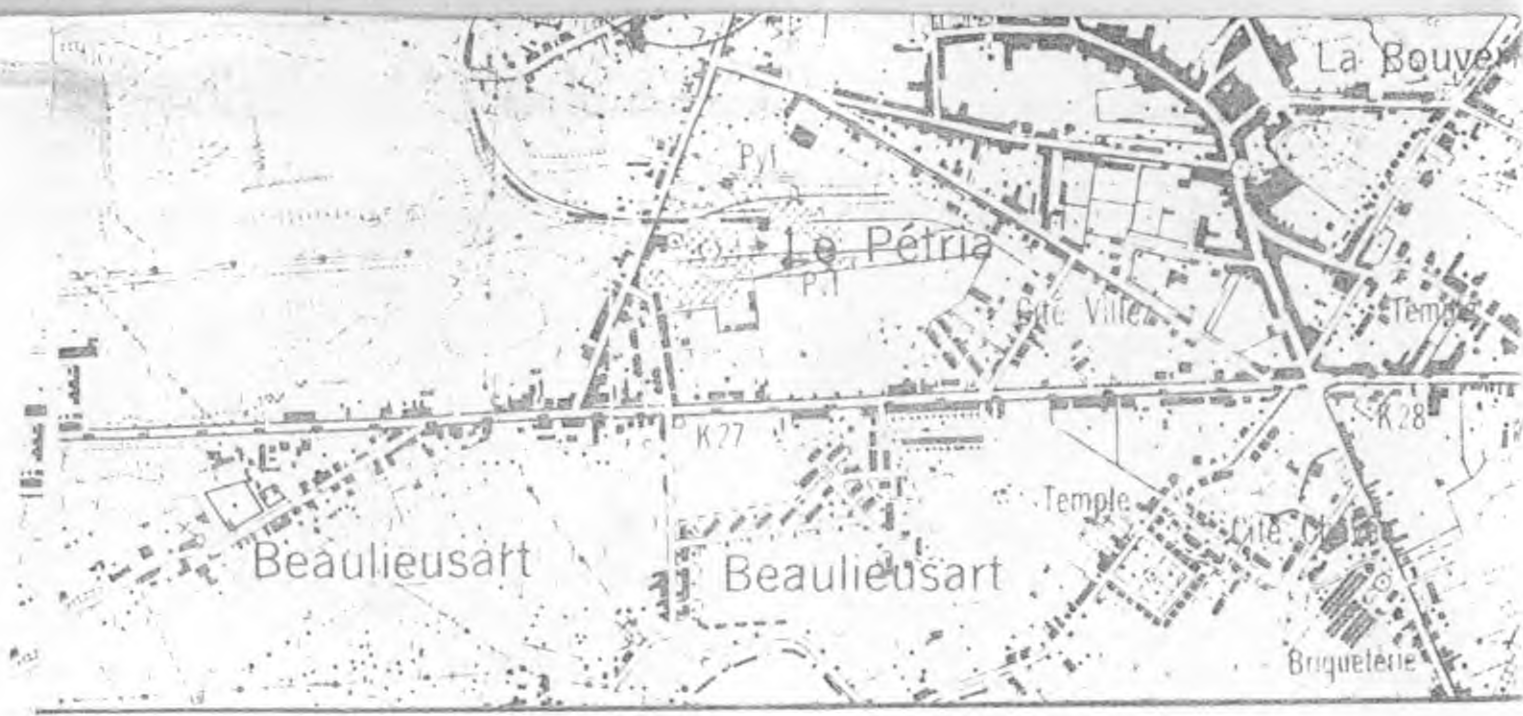
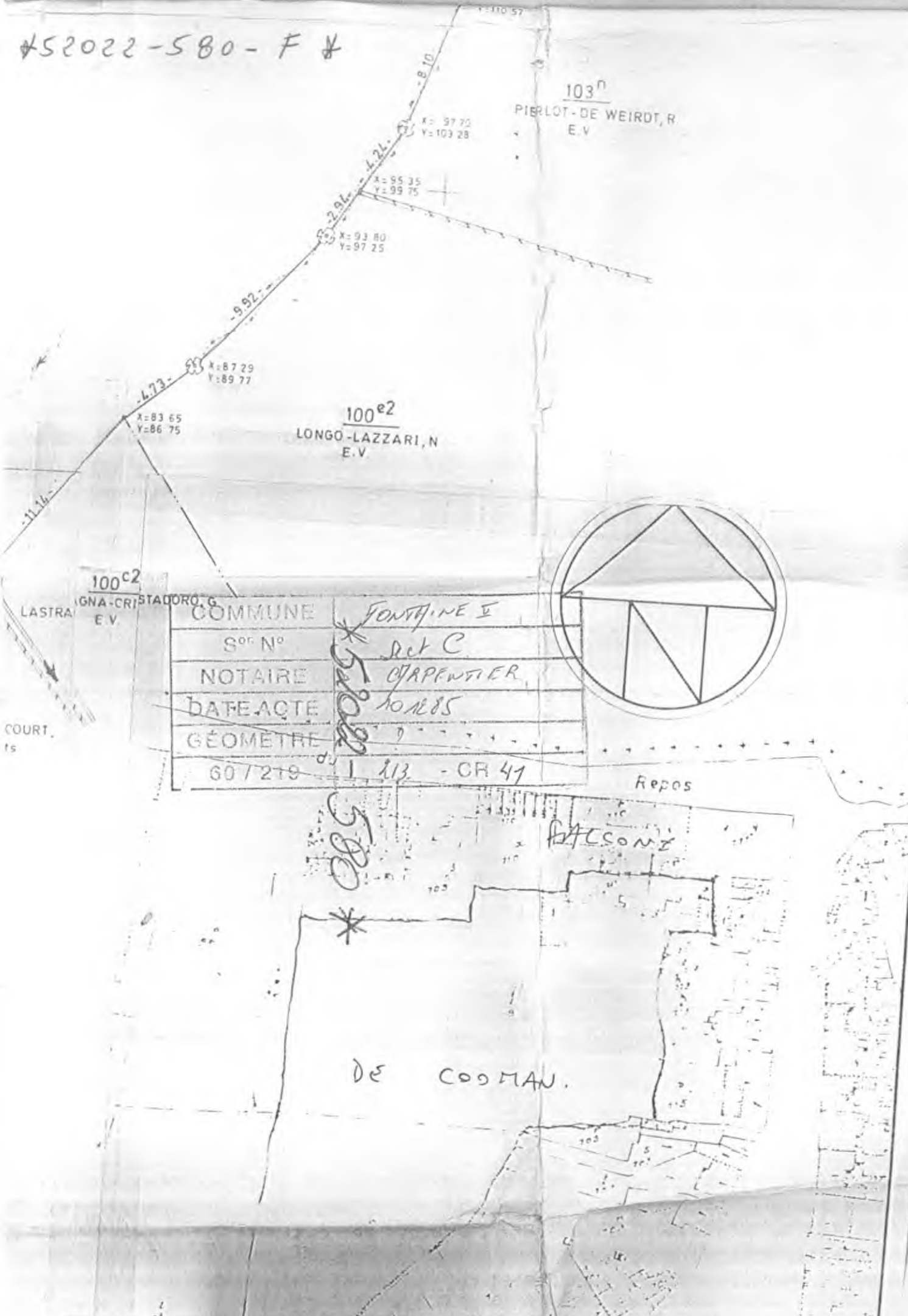

PROCES - VERBAL de MESURAGE et DIVISION

Ce passage devra toujours rester libre de toute entrave

#52022 - 580 - 6 *

100^{c2}
LONGO-LAZZARI, N
E.V.

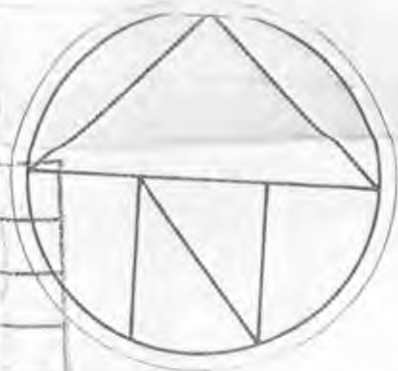

COMMUNE	FONTAINE V
8 ⁰ N ^o	Act C
NOTAIRE	CHARPENTIER,
DATE ACTE	10/08/85
GÉOMETRE	
60/219	1 113 - GR 47

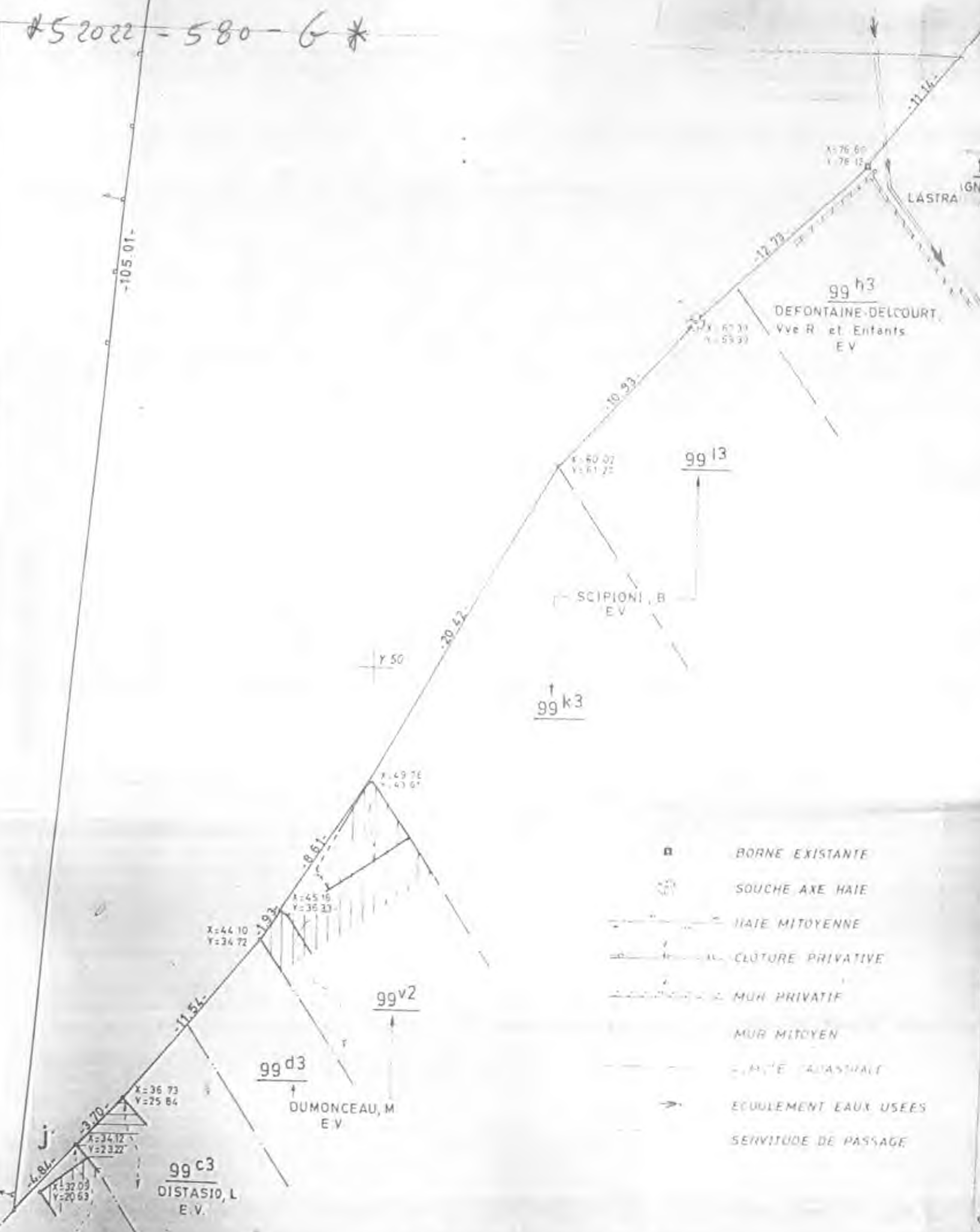

- BORNE EXISTANTE
- SOUCHE AXE HAIE
- HAIE MITOYENNE
- CLÔTURE PRIVATIVE
- MUR PRIVATIF
- MUR MITOYEN
- P.M.É. ADJANALTE
- EGOULEMENT EAUX USEES
- SERVITUDE DE PASSAGE

Echelle : 1/250

99 f3
BOON, Joseph
E.V.

PLAN DE DIVISION

52022-580-HH

100^{c2}
IGNA-CRISTADORO
RA E.V.

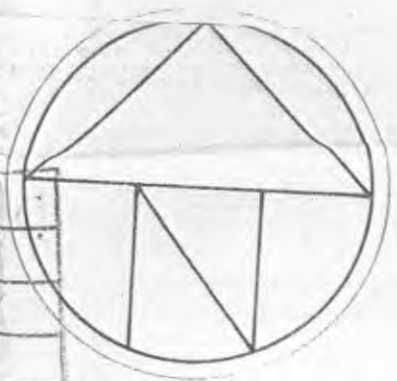

COMMUNE	FONTAINE V
S ^{or} N ^o	Det C
NOTAIRE	CHARPENTIER
DATE ACTE	10/12/85
GÉOMETRE	
607219	1 213 - CR 47

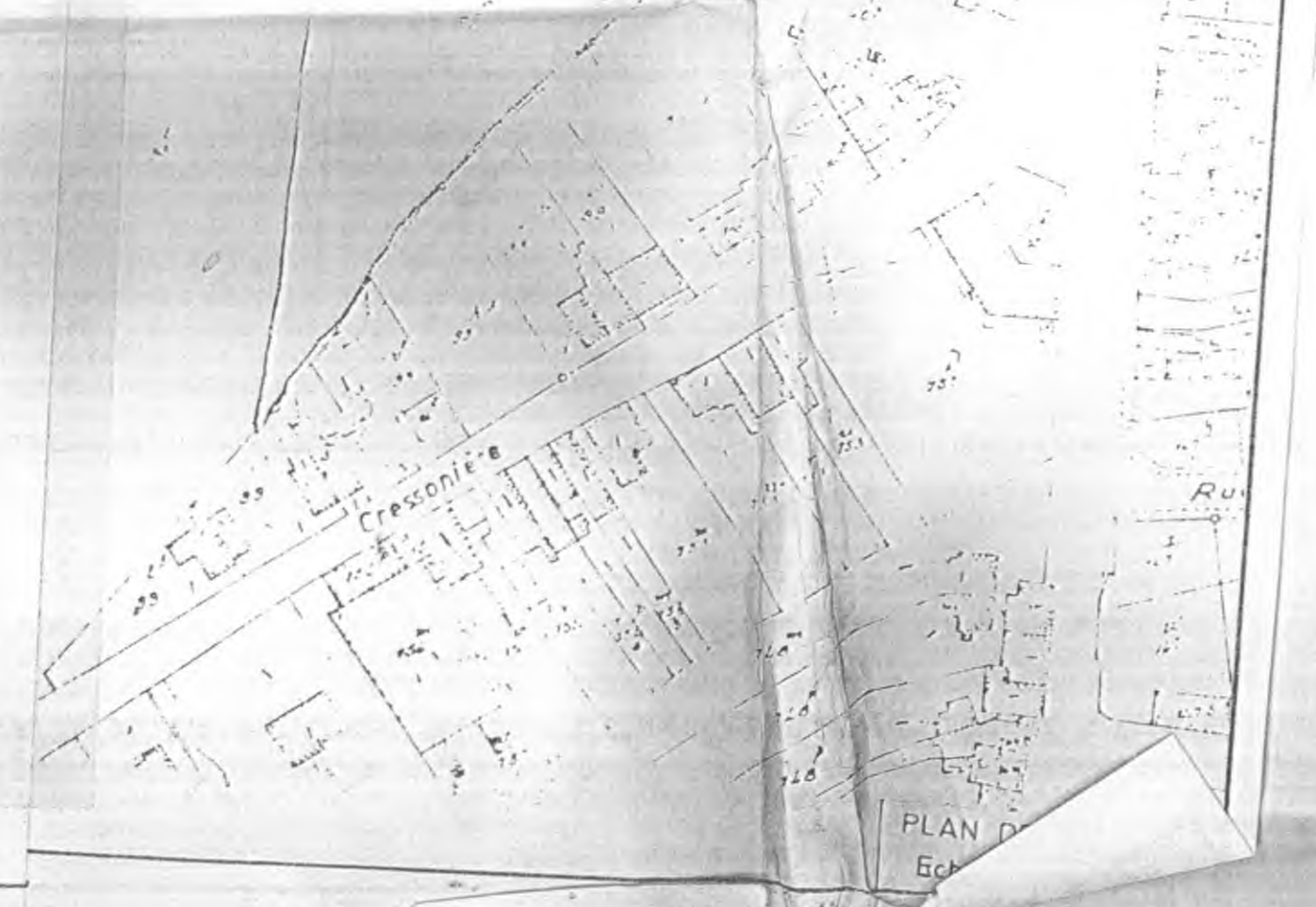

PLAN D
Ech

PROCES - VERBAL de MESURAGE et DIVISION .

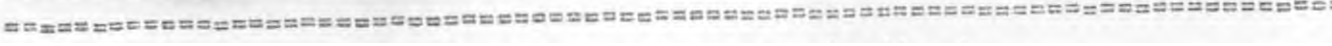

E. SAELENS . *E.S.*

85.12 - 866